

Section F

White Rose to Dewsbury Road

Dewsbury Road is a key route in south Leeds for local communities to access centres of education, employment and leisure. It is popular bus route which serves up to 22 buses per hour in each direction during peak times. Currently, buses are regularly delayed and journey times longer than they need to be. Our plan is to make existing bus services from and to Middleton, the White Rose and Dewsbury quicker and more reliable. The proposals seek to reduce delays to buses improving their reliability and punctuality.

We previously consulted on Cycle Superhighway facilities on Dewsbury Road between Garnet Road and Beeston Ring Road with construction due to start summer. We are proposing to extend segregated cycle facilities over 600m between Beeston Ring Road and the White Rose providing a direct traffic free route to local attractions.

Issues

- Dewsbury Road is a wide road, dominated by traffic and congestion
- The current road layout requires people cycling to mix with general traffic which is not safe, comfortable or attractive for most people
- Delay to bus journey times along the corridor

Opportunity

- Segregated one-way cycle tracks which connect with existing City Connect 3 proposals on Dewsbury Road. The proposals include improvements to pedestrian crossing facilities and footways along the route including shared pedestrian and cycle crossings. This will include conversion of the existing lane on Dewsbury Road into a bus lane. There is further opportunity to extend the Eastbound bus lane to the railway bridge on the ring road. This would further improve bus journey times.

- Join up existing parts of the Leeds cycle network to create a continuous segregated route for South Leeds
- Creation of new bus lanes on the approaches to Tommy Wass junction. This will include conversion of the existing running lane into a bus lane
- Improve landscaping along the route making it more desirable and increase biodiversity

Benefits

- Make travelling on foot and by cycle a convenient and direct choice for travelling along this route
- Expands segregated cycle network to key destinations
- Improvement in bus journey times

Section F: Proposed Extent of Highway Improvements

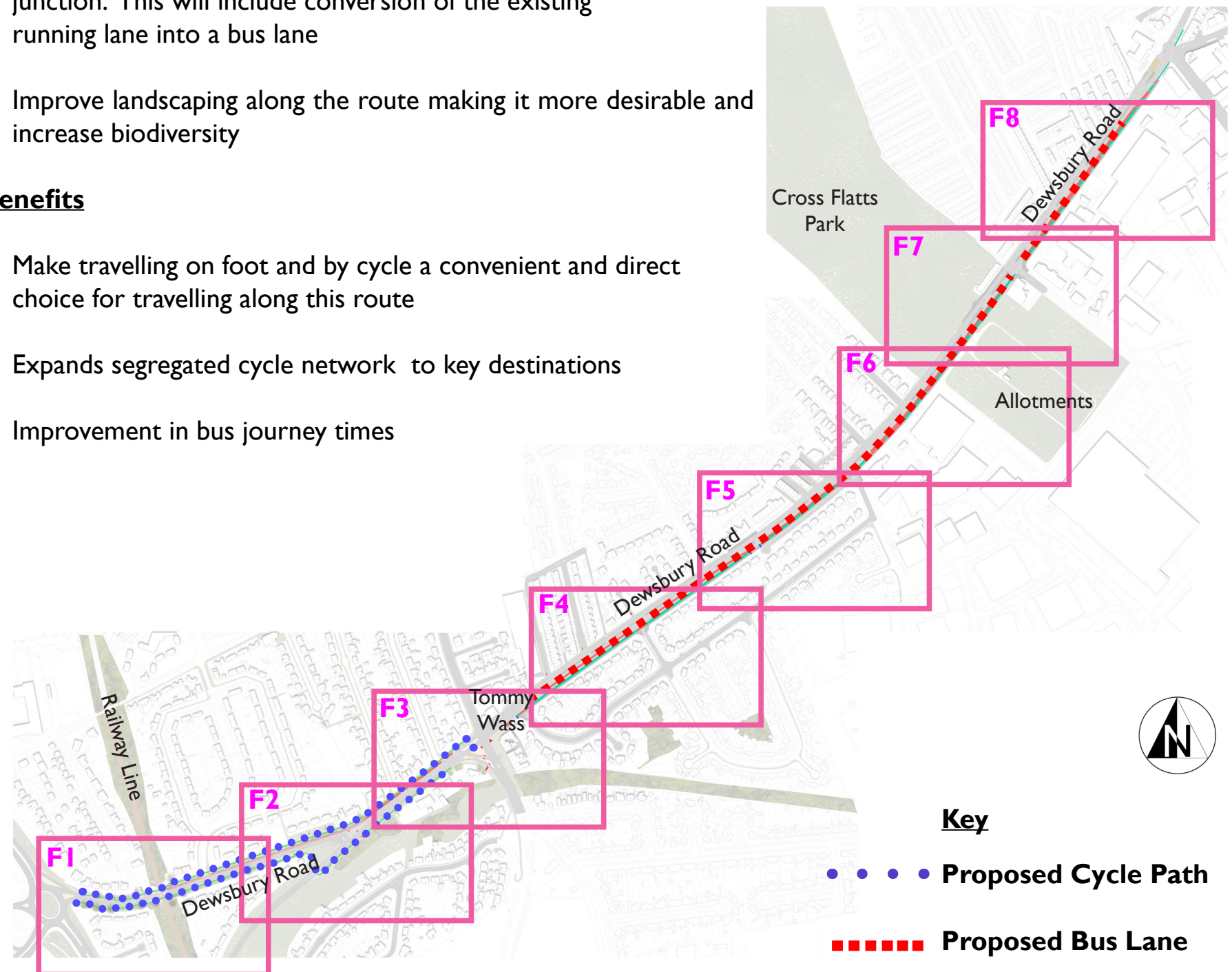

Developed and supported by:

Section F

FI

White Rose to Dewsbury Road

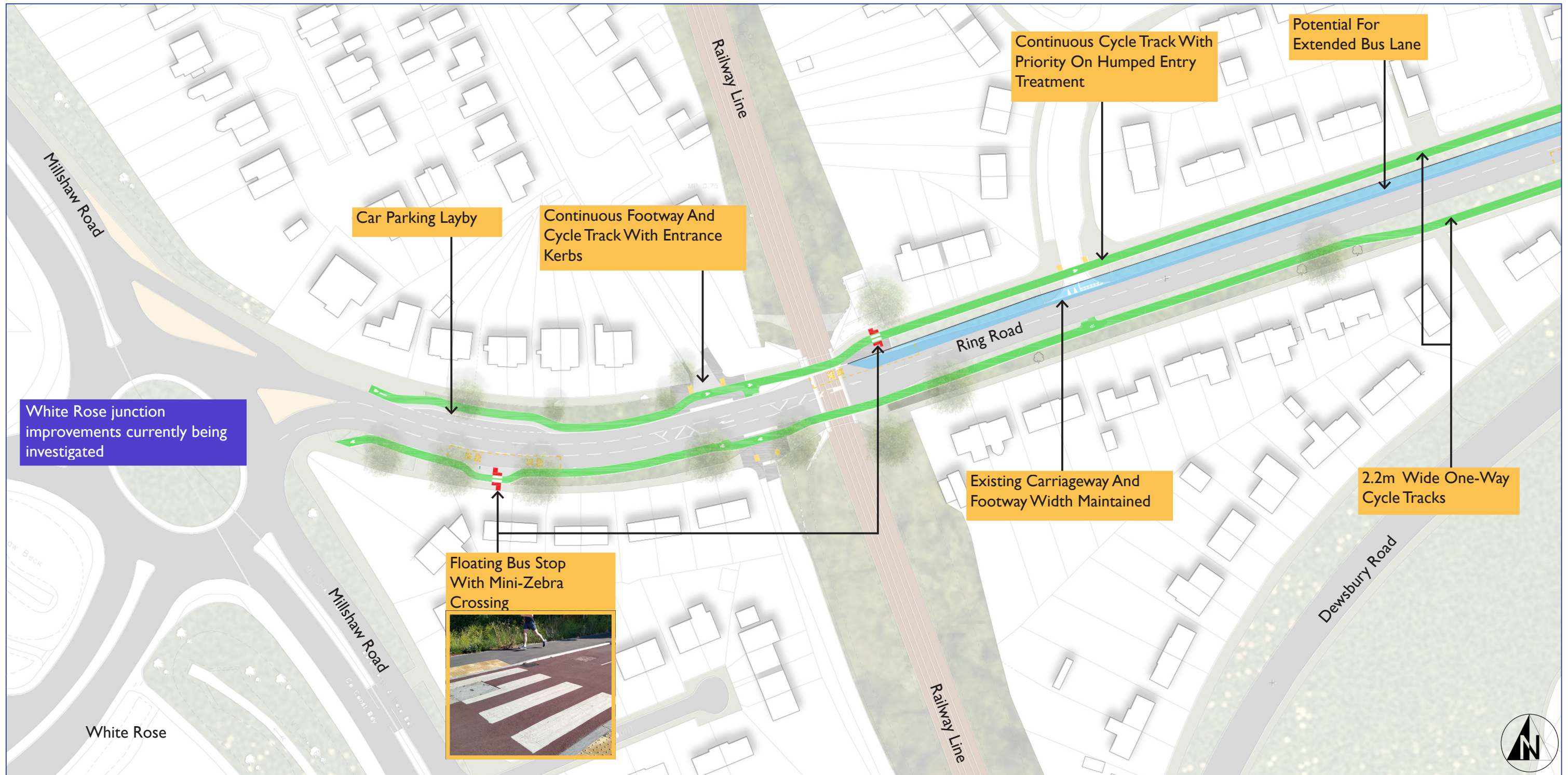

Developed and supported by:

Section F

F2

White Rose to Dewsbury Road

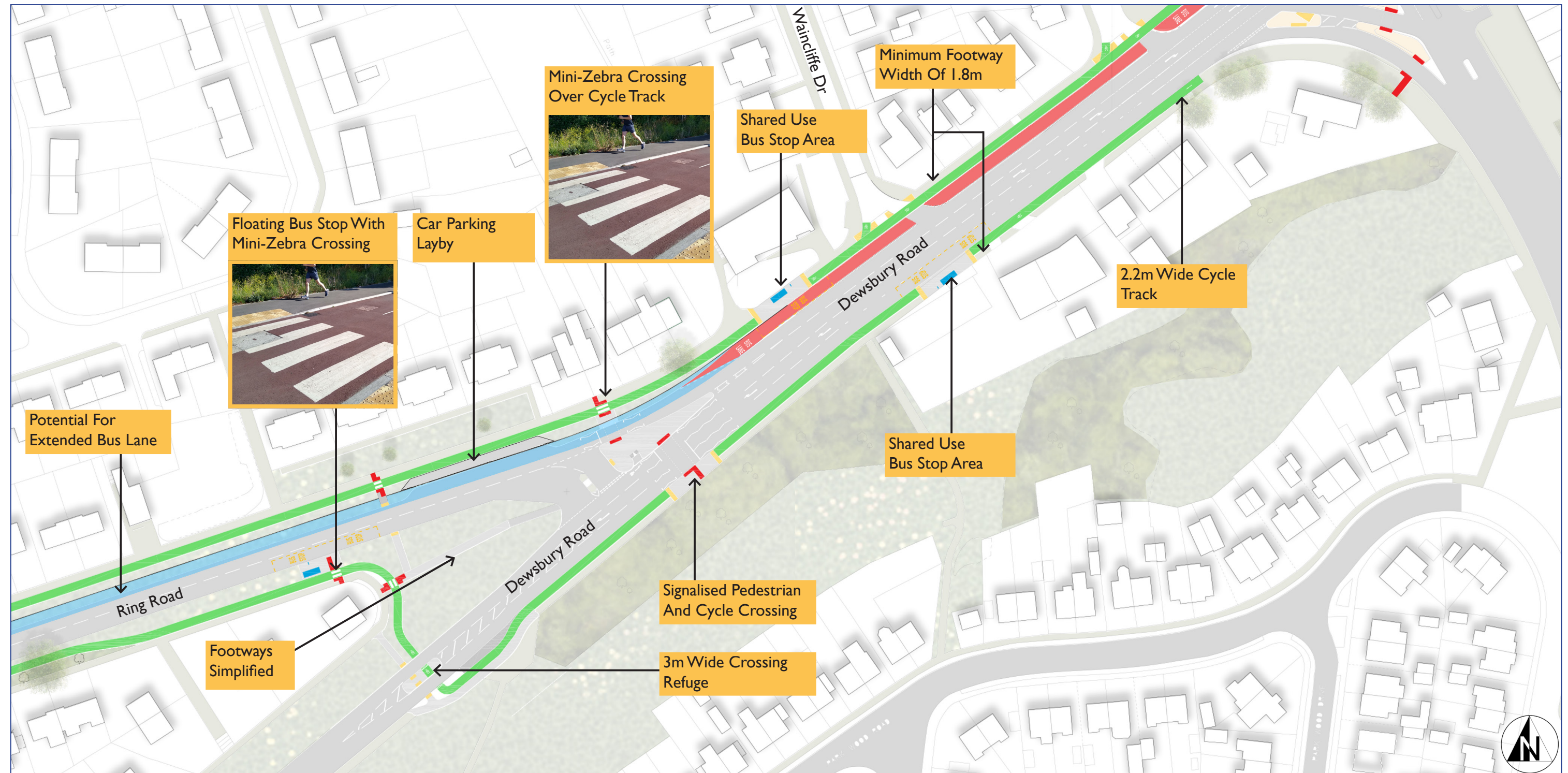
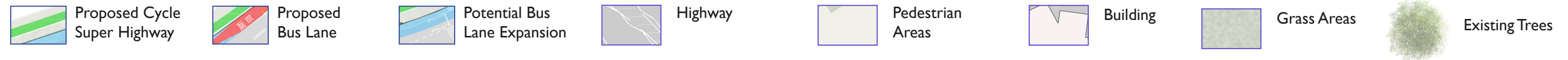

Developed and supported by:

White Rose to Dewsbury Road

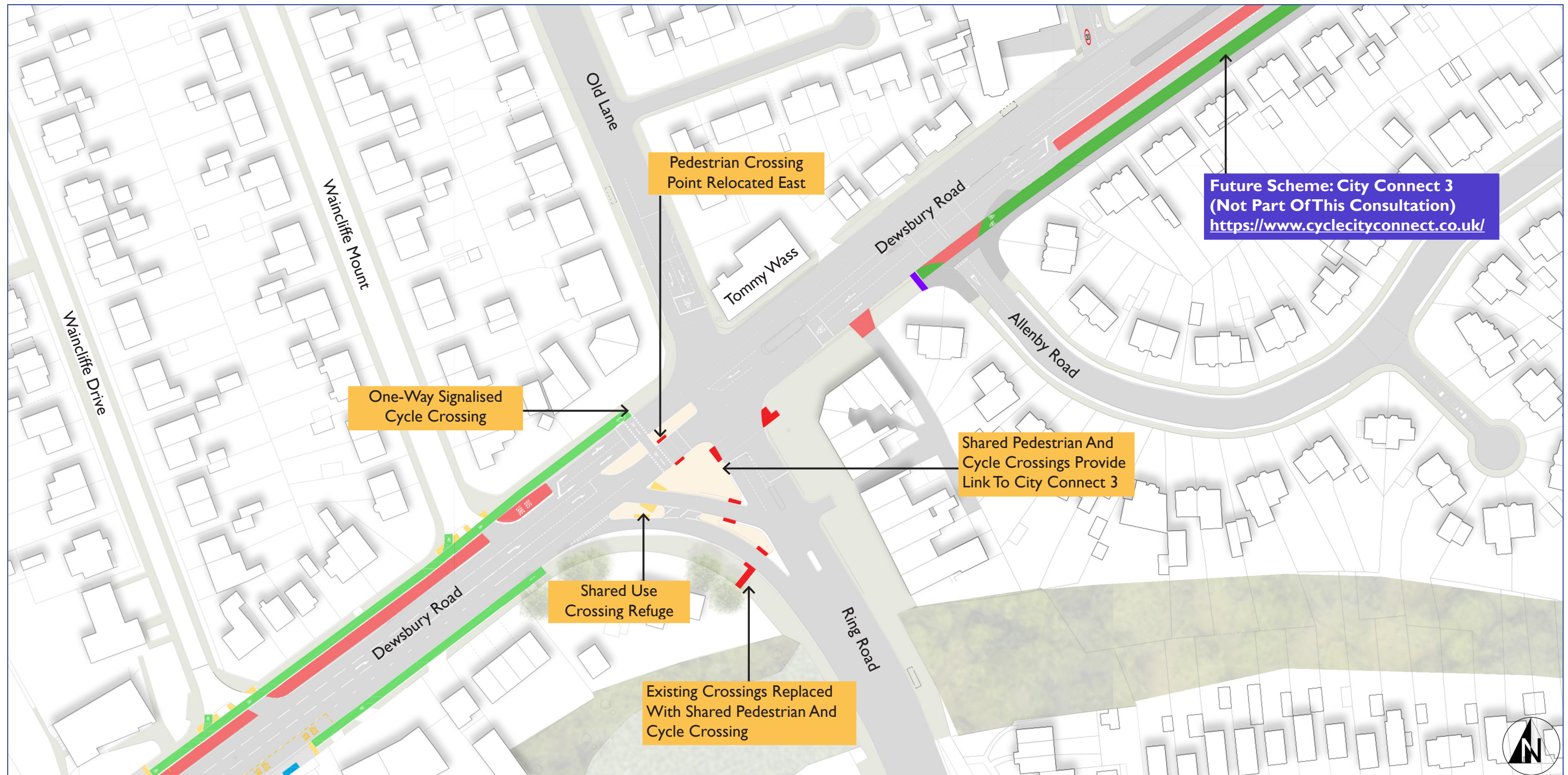

Developed and supported by:

Section F

F4

White Rose to Dewsbury Road

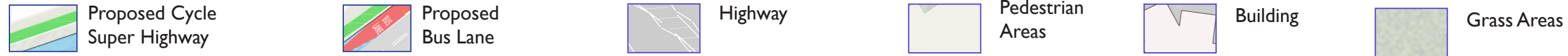

Developed and supported by:

Section F

F5

White Rose to Dewsbury Road

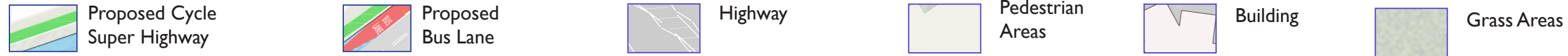

Developed and supported by:

Section F

F6

White Rose to Dewsbury Road



Developed and supported by:

Section F

F7

White Rose to Dewsbury Road

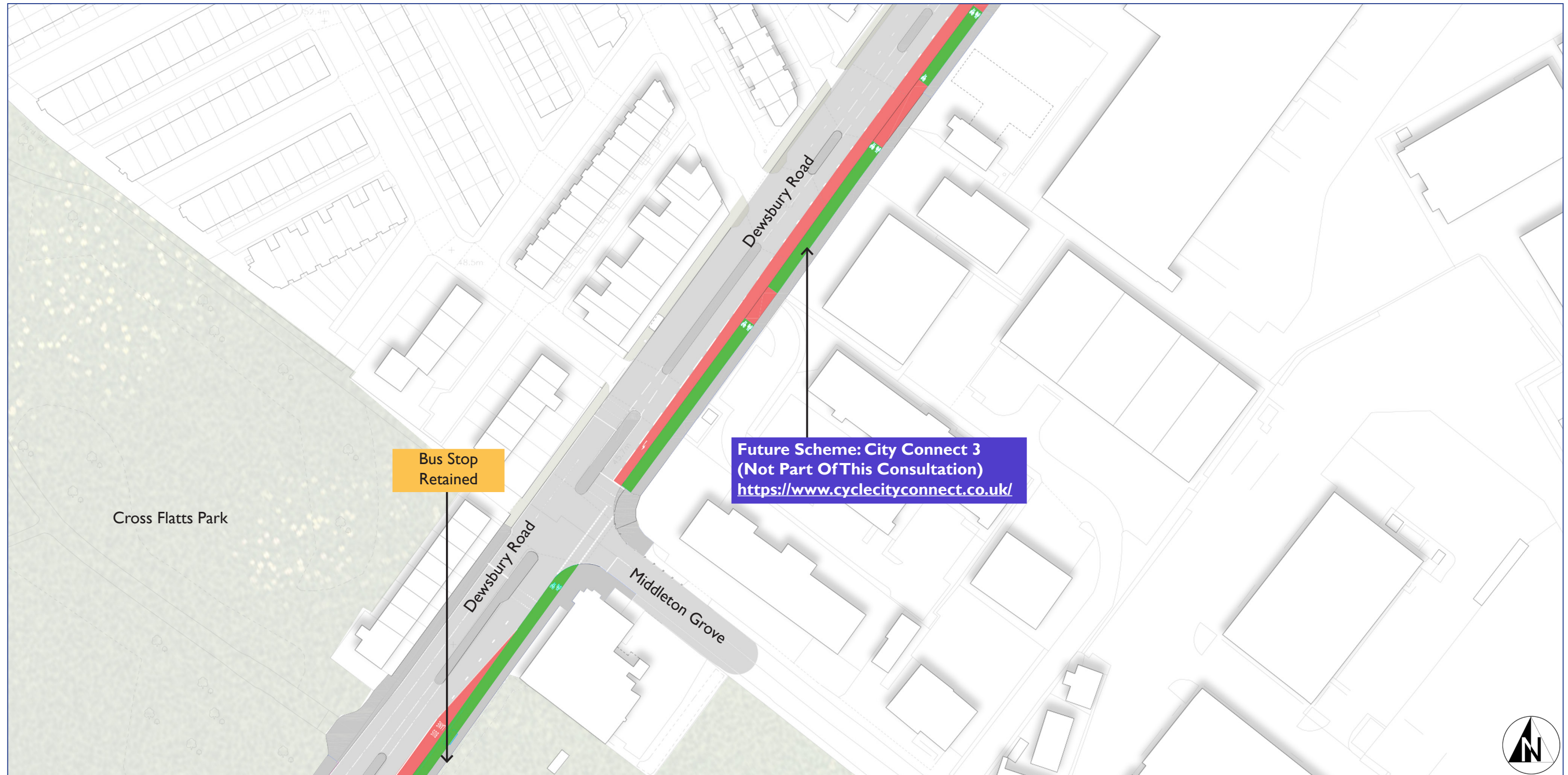
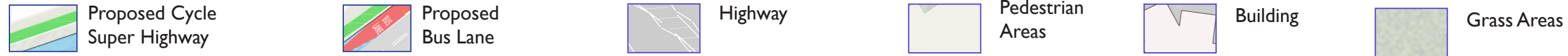

Developed and supported by:



Section F

F8

White Rose to Dewsbury Road

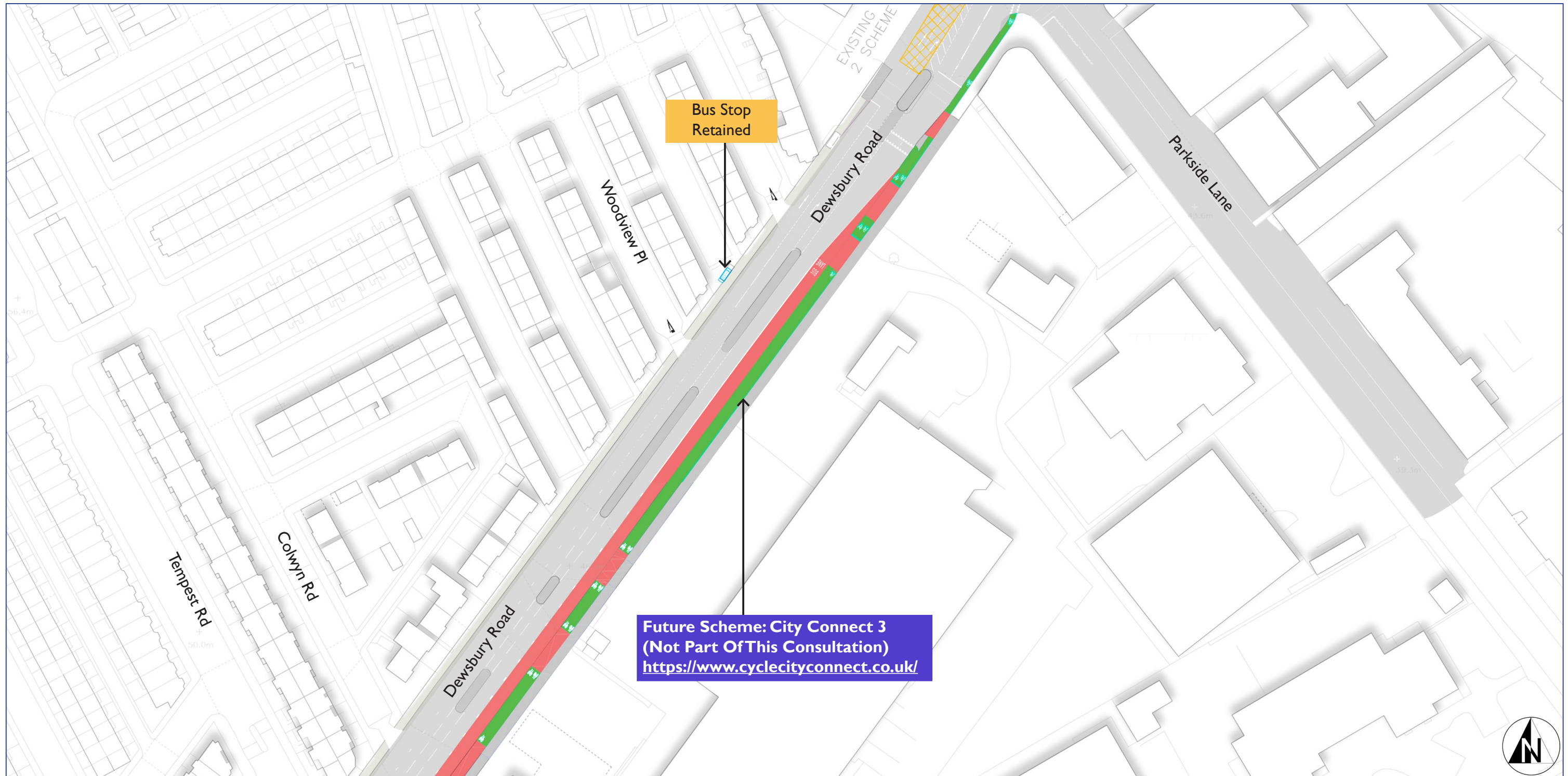

Developed and supported by: